

\*\*\*\*\*  
CLARION  
\*\*\*\*\*

BAY COUNTY GENEALOGICAL SOCIETY VOLUME 11 NUMBER 5  
NOVEMBER 1989

MEETING Our next meeting will be held on Tuesday the 7th of November which is Election Day. Please do not forget to vote before coming to the meeting. The program for the evening will be a tape of a presenter from the Michigan Genealogical Council Annual Seminar.

SOCIETY BUSINESS Our Council reps reported at our last meeting:

1. The State Library has extended its hours. Their new hours are: Mon. & Wed. from 9 a.m. to 9 p.m.; Tues., Thurs. Fri. & Sat. from 9 a.m. to 5 p.m.; Sun. from 1 p.m. to 5 p.m. Visitors to the Library are allowed up to four hours of free parking in the convenient lot behind the facility. All you will need to do is have a library staff person validate the parking ticket.
2. We are now able to obtain MGC lapel pins for \$3.00. Ruth and Hilda are able to take care of you if you want one of the pins;
3. The L.D.S. Library in Lansing now has Wayne Co. Probate records except for the City of Detroit.
4. Next year the national convention will take place in Washington, D.C. from the 6th to the 9th of June. A bus trip to the convention is now being planned. Further information related to this activity will be forthcoming.

We determined it might be of service to our members if we were to put Ancestor Sheets of our members in the Clarion each issue. This is a service of the Tuscola Co. Society, and seems to be an effective method of sharing information. This issue has two of Ruth Staudacher's sheets. We thank Ruth for providing them to us. Your comments related to this addition to the Clarion, other ideas you might feel would be helpful, or contributions for publication will be appreciated.

Methods of reading tombstones was another of our topics, and Ruth suggested using shaving cream and a squeegee. The shaving cream (cheap brands are fine) is sprayed upon the stone and squeegeed off. This gives good results and in no way harms the stone.

QUERIES Info re: THOMAS & SMITH families...Henry H. d. 1803, Maria L. d. 1885, Henry Randall d. 1885, James P. b. 1885, Bessie b. 1884, and Catherine d. 1893 of the surname Thomas and Thaddeus d. 1897, and Catherine d. 1897 of the surname Smith. Please send any info about births, marriages, deaths, etc. on the above to Jaqueline Hammon at 1421 S. Redwood Dr. in Mt. Prospect, IL 60056.

Info re: JOHN PETTEE/PITTIE/etc...Wife Esther and children, Mary, Phebe, Victoria, John S. or W. and Joseph. This family lived in Bay City ca 1860. Please send any info to Richard D. Ettinger at 23155 Hawthorne in Farmington, MI, 48024.

BAY COUNTY GENEALOGICAL SOCIETY  
 \*\* SPECIAL BULLETIN \*\*

The Executive Board met 18 April and determined we should communicate to you the items which follow, since it was felt you should have this information prior to the time of next scheduled newsletter in June.

The Board urges you to respond to a situation which exists in regard to original land records in Ontario. We have been advised that they have plans to destroy original land records which date from 1868 to 1947 and have apparently been microfilmed. We agree with many others interested in genealogy that it will be a mistake if that plan occurs.

Will each of you contact the following people, and ask that the destruction not happen? Letters need to go to:

Wm. Wrye, Minister of Consumer & Commercial Relations

9th. Floor, 555 Yonge St. Toronto, Canada, M7A2h7

and/or to

Hon. Lilly Oddie Monro, Minister Consumer & Culture Comm.

77 Bloor St., W. 6th. Floor Toronto, Can. M7A259

We also announce that the society is sponsoring a Heritage Quest Roadshow at the Fremont Ave. U. M. Church in Bay City on the 23rd. of May from 6:30-10:00 p.m. We hope you can attend this session, and invite others as well. The \$2.00 registration fee will cover refreshments. A map to Fremont is enclosed.

We also want to advise you that our next regular meeting will be held on Tues. May 2 at the South End Library on Lafayette. The program will include more work on our "How-To" book, and one or two tapes relating to the importance of historical considerations in genealogy.

Insert in: (

Family Pedigree Chart

(4.2) in Stand

<p>K 1.1          Owen Leslie SPAUDACHER          b. 17 July 1943          w. Cove, Arkansas          m. 19 June 1970          w. Rosehill, Kansas          d.</p> <p>(2nd marr.) nee Bell          Lynda Jean Ramsey          b. 17 February 1951          w. Salem, Arkansas          d.</p> <p>(1st marriage          Linda Carol Sanders          nee Colyer          m. 24 December 1966          d. July 1968</p> <p>CHILDREN:          Shawna Ashley          Tina Ellen (nee Ramsey)          Gina Carmen          Carie Kay</p>	<p>K 1.2          Leroy Carmon STAUDACHER          b. 26 March 1947          w. Cove, Arkansas          m. 22 May 1971          w. Wichita, Kansas          d.</p> <p>Carolyn June PALMER          b. 26 August 1952          w. Kansas City, Kansas          d.</p> <p>CHILDREN:          Vicki Sue          Jeffrey Lee</p>
--	---

K-3 = 4.2  
 Carmon KNIG  
 b. 30 January  
 w. Cove, Arka  
 d.

(2nd of 2



Insert in: Clarion, Volume II, Number 5, Nov. 1989

# Family Pedigree Chart

XI.

<p>K-1-1 Owen Leslie STAUDACHER          b. 17 July 1943          m. Cove, Arkansas          m. 19 June 1970          w. Rosehill, Kansas          d.</p> <p>(2nd marr.) nee Bell          Lynda Jean Ramsey          b. 17 February 1951          w. Salem, Arkansas          d.</p> <p>(1st marriage          Linda Carol Sanders          nee Colyer          m. 24 December 1966          d. July 1968</p> <p>CHILDREN:          Shawna Ashley          Tina Ellen (nee Ramsey)          Gina Carmen          Carle Kay</p>	<p>K-1-2 Leslie George STAUDACHER          b. 6 April 1911          w. Bay County, Michigan          m. 5 August 1939          w. Hatfield, Arkansas          d.</p> <p>(2nd of 5 children)          HEMPPEL          Evaline Josephine          b. 4 May 1890          w. Bay City, MI. 1213 Wills          d. 7 October 1952          w. Bay City, Michigan          (1st of 6 children)</p>	<p>K-1-3 Roy Carmon STAUDACHER          b. 26 March 1947          w. Cove, Arkansas          m. 22 May 1971          w. Wichita, Kansas          d.</p> <p>Carolyn June PALMER          b. 26 August 1952          w. Kansas City, Kansas          d.</p> <p>CHILDREN:          Vicki Sue          Jeffrey Lee</p>	<p>K-2-1 Edwin Bartholomaeus STAUDACHER          b. 20 August 1885          w. Bay Co. Monitor Twp.          m. 4 January 1904          w. Bay City, Michigan          d. 3 December 1975          w. Bay County, Michigan          (14th of 14 children)</p> <p>K-2-2 Charles Ernst HEMPEL          b. 12 October 1857          w. Leipzig, Germany          m. 15 January 1889          w. Bay City, Michigan          d. 1 October 1934          w. Bay County, Michigan</p> <p>K-2-3 Isabella Lucretia SHAW          b. 29 March 1869          w. Howick, Ontario, Canada          d. 19 August 1918          w. Bay County, Michigan</p> <p>K-2-4 John Alpheus KNIGHT          b. 23 October 1851          w. Gleason, Tennessee          m. 4 August 1874          d.</p> <p>K-2-5 Iga F. FREEMAN          b. 9 September 1853          w. Paducah, Kentucky          d.</p> <p>K-2-6 Dabney Evan KNIGHT          b. 20 March 1876          w. Gleason, Tennessee          m. 22 December 1902          w. Cove, Arkansas          d. 7 June 1957          w. Cove, Arkansas          (moved to Ark. 1901)          (1st of 6 children)</p> <p>K-2-7 Margaret Rebecca SCOTT          (Becky)          b. 1 June 1873          w.          d. 22 December 1933</p>	<p>K-3-1 George STAUDACHER          b. 1773 w. Germany          d. 1828 w. Germany</p> <p>Bartholomaeus STAUDACHER          7 marr. 22 Dec. 1822          b. 10 February 1828          w. Mosback bei Wandsheim          m. 29 October 1870 (2nd marr.)          w. Bay County, Michigan          d. 20 December 1910          w. Bay Co. MI. Monitor Twp.</p> <p>K-3-2 Johann Georg STURM          b. 1825 w.          m. Anna R. GEISSELSEIDER          19 marr. 20 Oct. 1849          w. Frankenthal, MI.          d. 1826/7 w.</p> <p>K-3-3 Johann Gottfried HEMPEL          b. 1825 w. Germany          d.</p> <p>K-3-4 Johann Sophie RICHTER          b. 1815 w. Germany          d. 1897 w. Germany</p> <p>K-3-5 Ithamer SHAW          b. 1838 w. Ont. Canada          d. 1927 w. Detroit, MI.</p> <p>K-3-6 Margaret DUNBAR          b. w. Ontario, Can.          d.</p> <p>K-3-7 Jack KNIGHT          b. w. Tennessee          d.</p> <p>K-3-8 Andrew SCOTT          b. 1811 w.          d. 1898          m. Rebecca          m. 6 July 1865          w. Arkansas          d. 1902 w.</p> <p>K-3-9 Joseph Freeman SCOTT          b. 28 May 1843          w. Kentucky          m. 6 July 1865          w. Arkansas          d. 5 March 1912          w. Polk Co. Arkansas</p> <p>K-3-10 N. Elizabeth KING          b. 3 October 1846          w.          d. 5 March 1913</p>	<p>K-4-1 Hans Leonard STAUDACHER          Germany          Rosina Mayer Suddersdorf          Germany</p> <p>K-4-2 George STAUDACHER          b. 1773 w. Germany          d. 1828 w. Germany</p> <p>K-4-3 Margaretha SEIBOLDIN          b. 1794 w. Germany          d. 1844 w. Germany</p> <p>K-4-4 Johann Adam STURM          Petersdorf, Germany          Anna Margaretha GOES          Johann Lorenz GEISSELSEIDER          Ansbach, Germany          Margaretha Barbara EMMETT          Klein-Haslach, (Ansbach) Ger.          Johann Gottfried HEMPEL          Johanne Rosine BÖHLIG</p>
---	--	--	---	--	--



**FAMILY GROUP NO.**

**Husbands Full Name Bartholomaeus STAUDAACHER**

**FAMILY GRC:P NO.**

**Husbands Full Name Bartholomaeus Staudacher**

Information Obtained From:	Day	Month	Year	City, Town or Place	County of Residence, etc.	State or County	Add info on husband
St. Paul's Lutheran Church Records	10 Feb.	1828	Mosbach bei Windsheim	Mittelfranken, Ger			
Frankenlust Twp. Bay Co., Michigan	25 April	1854	St. Paul's Bay Co., Michigan				
Bay Co., Michigan	20 Dec.	1910	Bay Co., Michigan				

Information Obtained From:	Day	Month	Year	City, Town or Place	County of Residence, etc.	State or County	Add info on husband
St. Paul's Lutheran Church - Frankenlust Bay Co. Mich. (last)	25 April	1854	2nd marr.	12 June 1872			
Portrait & Biograph	20 Dec.	1910	Bay Co., Michigan				
Record, Seigmaw & Carr. & emigrated the same year							
landed N.Y. bought in 1855 250 A. Hampton Twp. Sec. 25 Monitor							
160 acres							

Place of Residence	Occupation if other than housewife	Church Affiliation	Notes
Bay Co., Michigan		Lutheran	
Bay Co., Michigan		Lutheran	
Bay Co., Michigan		Lutheran	

Place of Residence	Occupation if other than housewife	Church Affiliation	Notes
Bay County, Mich.		St. Paul's Lutheran Frankenlust, Bay Co	
Bay County, Mich.		St. Paul's Lutheran Frankenlust, Bay Co	
Bay County, Mich.		St. Paul's Lutheran Frankenlust, Bay Co	

Wife's Full Maiden Name	Elizabeth	Margaretha	Grubser (Gruber)	Barbara Seiboldin
U.S. 1854 (left Bremen 1848) * discrepancy				
Generation of Family	(2) Anna Barbara Sturk			
Other names of wife	Margaretha Staudacher			

Wife's Full Maiden Name	Anna	Barbara	Sturm
State of Residence	State Road (Salzburg)	Bay County, Michigan	
Occupation if other than housewife	Farmer & store	St. Paul's Lutheran Frankenlust, Bay Co	
Other names of wife	(1) Elizabeth Margaretha Gruber (Gruber)		
Other names of husband	Margaretha Seiboldin		

Complete	Address	City, State	Notes
	300 McCormick	Bay City, Mich.	
	1986	Bay City, Mich.	

Complete	Address	City, State	Notes
	300 McCormick	Bay City, Mich.	
	1986	Bay City, Mich.	

1 Margaret	5 July 1853	Bay Co. Mich.
Full Name of Spouse*		
Henry Reinhardt		

10 (Henry)	5 June 1873 or July 5, 1872?	Bay County, Mich.
Full Name of Spouse*		
Johann Heinrich		

2 Jacob	4 April 1856	Bay Co. Mich.
Full Name of Spouse*		
Carolina Dabina		
Johanna Deneke		

11 2 (Regina)	3 Sept. 1876	Bay County, Michigan
Full Name of Spouse*		
Anna Regina		

3 Friedrich Johann	24 Jan. 1858	
Full Name of Spouse*		
Karina Barbara <td></td> <td></td>		
Arnold <td></td> <td></td>		

12 George Hollandmorriz	20 June 1879	West Bay City, Michigan
Full Name of Spouse*		
Barbara Wegener		
born 1861 d. 1945 Fremont Cem. Bay Co. Mich.		

4 Georg Adam	20 May 1820	
Full Name of Spouse*		
Anna Johanna Deneke		
she b. Frankenlust, 15 April 1824 d. 25 June 1898		

13 (Adeline)	26 June 1883	Bay County, Michigan
Full Name of Spouse*		
Johanna Adellina		
was to have marr. William Mickel but he died 18 May 1910		

5 Georg Michael	14 Dec. 1861	
Full Name of Spouse*		
Johann George Hanni		
2 May 1953 Bay City, Michigan		

14 (Edwin)	20 Aug. 1885	Bay County, Michigan
Full Name of Spouse*		
Edwin Bartholomaeus		
(1) 4 Jan. 1903 (2) Josephine Teatro		
Evaline J. Hempel b. 4 May 1890 d. 7 Oct. 1952		

6 Johann George Hanni	8 Jan 1864	
Full Name of Spouse*		
Bellevue FELKER		

6		
Full Name of Spouse*		

7 Maria Barbara	5 April 1866	Monitor Twp. Bay Co., Michigan
Full Name of Spouse*		
Stigle		

7		
Full Name of Spouse*		

8 Johann Michael	15 Feb. 1868	
Full Name of Spouse*		
Antonia Kloha		
Jan. 1955 Kloha b. West Prussia 7 May 1876 d. 27 Jan. 1910		

8		
Full Name of Spouse*		

9 Adam (Georg)	20 April 1870	
Full Name of Spouse*		
Maria Marg. Johann Reuther		
8 Jan. 1952 7 Father Christoph Reuther Maria Margaretha geb. Grammel		

9		
Full Name of Spouse*		

10		
Full Name of Spouse*		

10		
Full Name of Spouse*		

\* If married more than once No. each mar. (1) (2) etc. and last in "Add info. on children" column. Use reverse side for additional children, other notes, references or information.

\* If married more than once No. each mar. (1) (2) etc. and last in "Add info. on children" column. Use reverse side for additional children, other notes, references or information.

Your Father's Name:

2. Frank H. HARRINGTON  
Date Born: 2 Oct. 1892  
Where Born: Paynes, Mich.  
Date Married: 31 May 1912  
Date Died: 3 Jan. 1956  
Where Died: Bay City, Mich.

Your Name:

1. George William HARRINGTON  
Date Born: 5 March 1915  
Where Born: Bay City, Mich.  
Date Married: 6 Mar. 1946  
Where Married: Bay City, MI.

Name of Your Husband (or Wife):

Lottie F. McClung  
Date Born: 10 Feb. 1920  
Where Born: Port Huron, MI.

Your Mother's Name:

3. Harriette H. LUEBKE(LIPE)  
Date Born: 10 Dec. 1895  
Where Born: Bay City, Mich.  
Date Died: 21 Mar. 1985  
Where Died: Bay City, Mich.

Name of Your Father's Father:

4. Frederick Wm. HARRINGTON  
Date Born: 13 Apr. 1866  
Where Born: New Haven, N.Y.  
Date Married: 2 Jan. 1892  
Date Died: 26 Apr. 1892  
Where Died: Omer, Mich.

Name of Your Father's Mother:

5. Stella BARBER  
Date Born: 3 Apr. 1876  
Where Born: New York  
Date Died: 13 Apr. 1942  
Where Died: Bay City, Mich.

Name of Your Great Grandfather:

10. Judson BARBER  
Date Born: Jan. 1857  
Where Born: PA.  
Date Married:  
Date Died:

Name of Your Great Grandmother:

11. Mary WARNER  
Date Born: Oct. 1854  
Where Born: N.Y.  
Date Died:

Name of Your Great Grandfather:

12. Carl LUEBKE  
Date Born:  
Where Born:  
Date Married:  
Date Died:

Name of Your Great Grandmother:

13.  
Date Born:  
Where Born:  
Date's Died:

Name of Your Great Grandfather:

14. William BARTZ  
Date Born:  
Where Born:  
Date Married:  
Date Died:

Name of Your Great Grandmother:

15.  
Date Born:  
Where Born:  
Date Died:

Name of Your Great Grandfather:

8. Francis L. HARRINGTON  
Date Born: CT.  
Where Born:  
Date Married: 13 Nov. 1857 N.Y.  
Date Died: 27 Sept. 1866

Name of Your Great Grandmother:

9. Ophelia KEEF (KIEF)  
Date Born: 20 June 1843  
Where Born: New Haven, N.Y.  
Date Died: 8 Aug. 1903 Clare, MI.

Genealogy Letter-Pedigree

© 1976, P.S. Copyright by The Everton Publishers, P.O. Box 368, Logan, Utah 84301, publishers of THE GENEALOGICAL HELPER. Send for a free catalogue with lists and full descriptions of many genealogical aids.

de Harrington  
607 Sandra Ct.  
Bay City, Mich. 48708

Your Name:

1 Lottie Fay McClung

Date Born: 10 Feb. 1920

Where Born: Port Huron, Mich.

Date Married: 6 March 1947

Where Married: Bay City, MI.

Name of Your Husband (or Wife):

George Wm. Harrington

Date Born 5 March 1915

Where Born Bay City, Mich.

Your Father's Name:

2 John Alexander McClung

Date Born: 30 Dec. 1883

Where Born: Cayuga, Ontario

Date Married: 10 May 1905

Date Died 19 June 1963

Where Died Ovid, Mich.

bur. Snover, Mich.

Name of Your Father's Father:

4 Robert James McClung

Date Born 9 March 1856

Where Born: Cayuga, Ontario

Date Married: 4 May 1881

Date Died: 5 Jan. 1933

Where Died Lyndoch, Ontario

Name of Your Father's Mother:

5. Elizabeth Smith

Date Born: 10 Sept. 1854

Where Born Kohler, Ontario

Date Died 25 Dec. 1944

Where Died Durand, Mich.

At son's home.

Name of Your Mother's Father:

6. John Russell Dorman

Date Born 30 July 1859

Where Born Brant, Ontario

Date Married 23 Oct. 1878, Ont.

Date Died 12 Aug. 1939

Where Died Snover, Mich.

Your Mother's Name:

3 Florence Ethel Dorman

Date Born 26 Feb. 1886

Where Born: Snover, Mich.

Date Died 15 Jan. 1959

Where Died Ft. Ogdens, Fla.

bur. Snover, Mich.

Name of Your Great Grandfather:

8 David (Butcher) McClung

Date Born 2 Mar. 1796

Where Born Killisfaddy, Ireland

Date Married: 25 Mar. 1832, Ire.

Date Died 26 Jan. 1888, Cayuga

Name of Your Great Grandmother:

9 Eliza Slater

Date Born: 8 July 1814

Where Born Killisfaddy, Ireland

Date Died: 27 Jan. 1881, Cayuga, Ontario

Name of Your Great Grandfather:

10 John Phillip Smith

Date Born: 1819

Where Born: Germany

Date Married:

Date Died: 1898, Canada

Name of Your Great Grandmother:

11 Catherine M. ALBERT

Date Born 1824

Where Born Germany

Date Died 1903, Canada

Name of Your Great Grandfather:

12 James Erwin Dorman

Date Born 20 Dec. 1821

Where Born N.Y.

Date Married 24 Dec. 1840, Ont.

Date Died 20 Jan. 1900

Name of Your Great Grandmother:

13 Caroline Smith

Date Born Nov. 1823

Where Born Ontario

Date Died 28 Mar. 1897

Name of Your Great Grandfather:

14 John Wesley Forsyth

Date Born 10 Aug. 1832

Where Born Ontario

Date Married 14 Oct. 1856, Ont.

Date Died July 1911

Name of Your Great Grandmother:

15 Margaret Ann Kennedy

Date Born 3 Feb. 1839, Ont.

Where Born Ontario

Date Died 11 Jan. 1923

London, Ontario

Genealogy Letter-Pedigree

Form P5. Copyright by The Everton Publishers, P.O. Box 368, Logan, Utah 84321, publishers of THE GENEALOGICAL HELPER. Send for a free catalogue with lists and full descriptions of many genealogical aids.

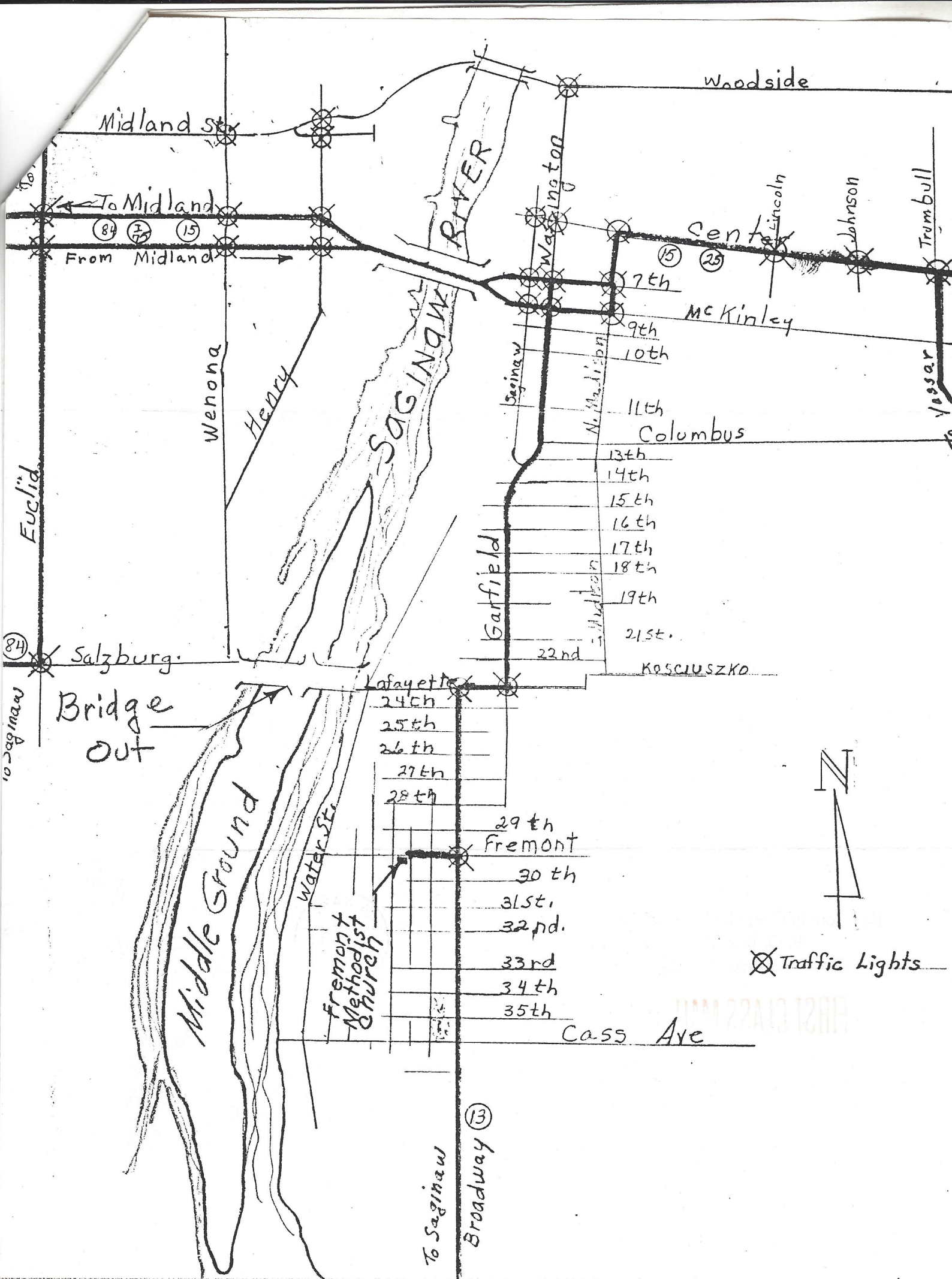

Woodside

Midland St

SAGINAW RIVER

To Midland  
From Midland

Washington

Center

McKinley

Wenona

Henry

SAGINAW

Saginaw

N. Madison

Columbus

Trumbull

Vassar

Euclid

Garfield

7th  
9th  
10th  
11th  
13th  
14th  
15th  
16th  
17th  
18th  
19th

21st

Kosciuszko

Salzburg

Bridge Out

Lafayette  
24th  
25th  
26th  
27th  
28th

29th  
Fremont  
30th  
31st  
32nd  
33rd  
34th  
35th

Middle Ground

Water St.

Fremont Methodist Church

To Saginaw

Broadway 13

Cass Ave



X Traffic Lights